

# Recess 4.5"

## Infinite Color+ Adjustable

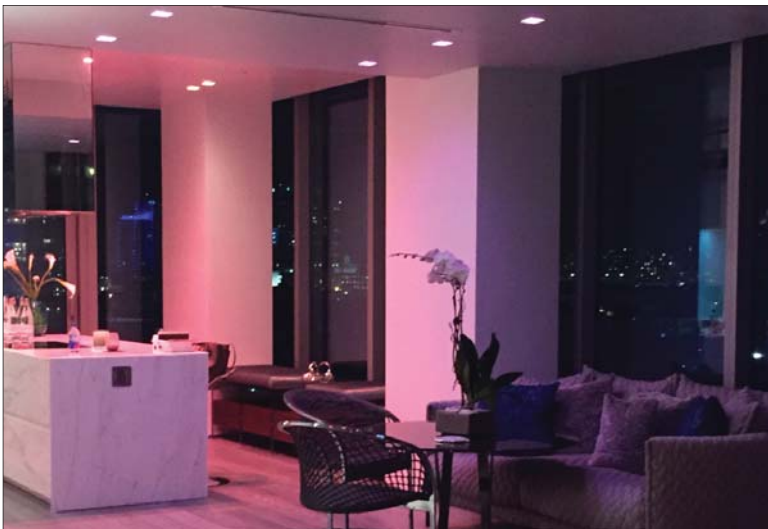

### Recess 4.5 inch Infinite Color+ Adjustable

An elegant solution for a variety of applications. Featuring clean, architectural grade finishes and full dynamic color plus tunable architectural white light capability, the Recess 4.5 installs beautifully into all ceiling types, including drywall, stone, and wood and makes every space look its best.

- **Ideal Applications:** Medium to Large-Scaled Spaces
- **Recommended for Ceiling Height:** 14' – 20'
- **Light Type:** Saturated, colorful light, pastels, neutrals and whites, tunable and dynamically variable to suit your preference

### 4.5" ADJUSTABLE PERFORMANCE DATA

Infinite Color+

	White Light Channel Only	Multi Channel Output
Delivered Lumens:	975	1175
Lumens Per Watt:	43	37
Source Lumens:	1450	1725
Wattage	23W	32W
Beamspread:	35°	
	Narrow Beam / Adjustable	

#### Round Trims



#### Square Trims



Universal and Field Convertible - Trim | Trimless | Millwork

#### 4' SPACING BETWEEN LIGHT FIXTURES

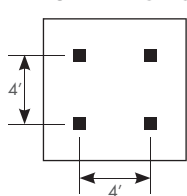

4' x 4' LAYOUT	CEILING HEIGHT
Light levels at:	8' 10' 12' 14' 16' 18' 20'
Light levels on Work Plane (2.5' AFF):	54 48 43 39 35 32 29 (fc) foot candles

#### 5' SPACING BETWEEN LIGHT FIXTURES

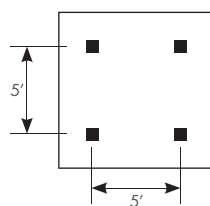

5' x 5' LAYOUT	CEILING HEIGHT
Light levels at:	8' 10' 12' 14' 16' 18' 20'
Light levels on Work Plane (2.5' AFF):	44 39 36 33 30 28 26 (fc) foot candles

#### 6' SPACING BETWEEN LIGHT FIXTURES

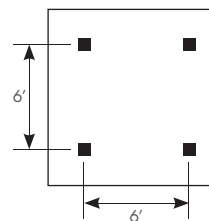

6' x 6' LAYOUT	CEILING HEIGHT
Light levels at:	8' 10' 12' 14' 16' 18' 20'
Light levels on Work Plane (2.5' AFF):	30 29 28 27 25 24 22 (fc) foot candles

#### 8' SPACING BETWEEN LIGHT FIXTURES

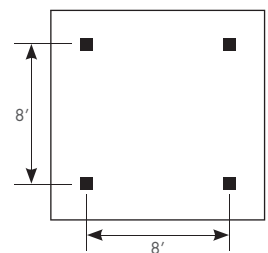

8' x 8' LAYOUT	CEILING HEIGHT
Light levels at:	8' 10' 12' 14' 16' 18' 20'
Light levels on Work Plane (2.5' AFF):	22 19 17 15 14 13 12 (fc) foot candles

Spacing Criteria = 0.60

Average light levels are provided in the tables above, for a range of lighting fixture layouts and ceiling heights. All illuminance values are reported in average footcandles (fc) and measured at the workplane, 30" above the floor.

# Recess 4.5" Infinite Color+ Adjustable



## Four Easy Steps to Specify

### 1 Select Housing Type

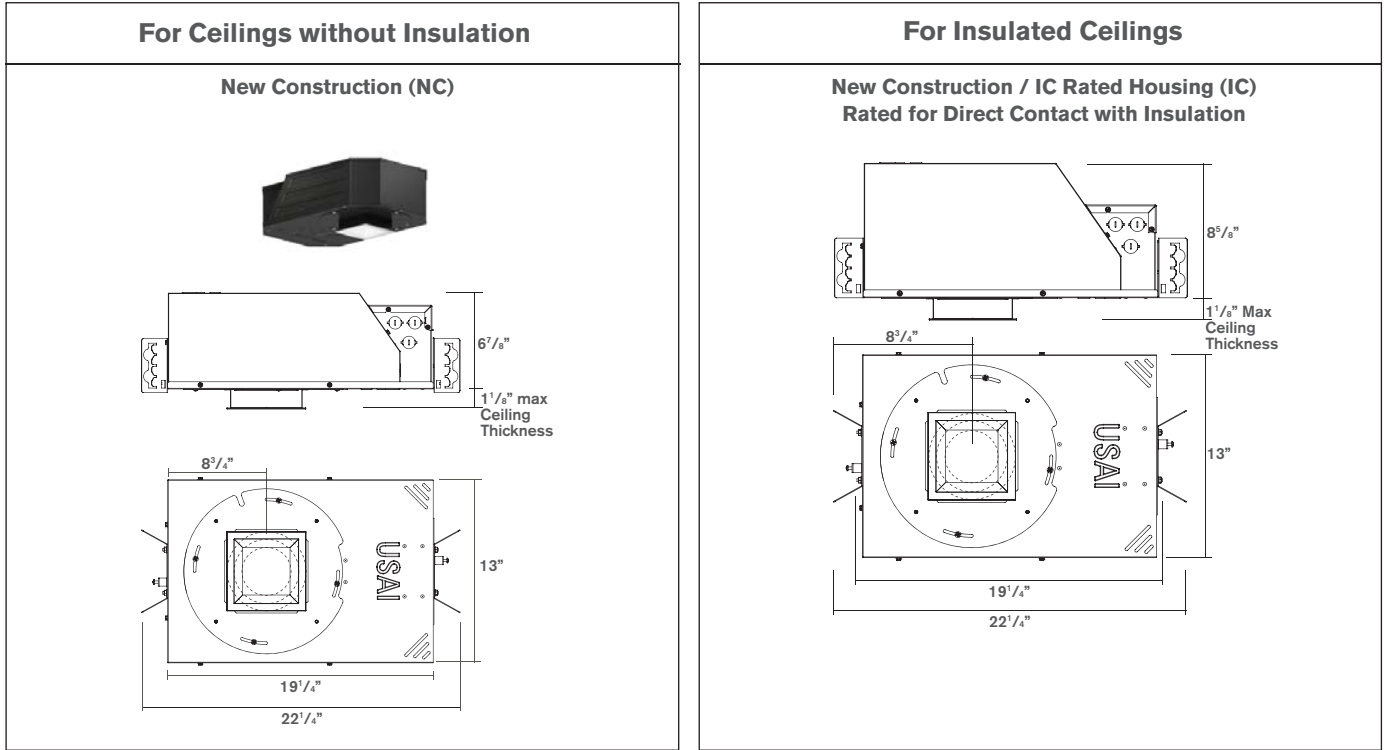

### 2 Select Shape

Square

Round



### 3 Select Trim Style For Ceiling Type

**Trimmed (F)**  
for All Ceiling  
Types

**Trimless (P)**  
for Sheetrock Ceilings Only  
(Must be Spackled In)

**Millwork (M)**  
for Millwork and  
Stone Ceilings



# Recess 4.5" Infinite Color+ Adjustable



## 4 Select Trim Finish



## How to Specify

Manufacturer	Light Fixture Type			LED + Control			Options				Revision
<b>USAI</b>	<b>4DL</b>	<b>A1</b>		<b>FC1</b>	<b>IX32A</b>			<b>F</b>	<b>S</b>		<b>00</b>
USAI	Family	Function	Housing Type	LED Color	Wattage Driver	Shape	Style	Beam Spread	Lens	Finish	Version
<b>USAI Lighting</b>	<b>4DL</b> 4.5" Downlight, 32W	<b>A1</b> Adjustable Tilt and Aim Downlight	<b>NC</b> New Construction Housing  <b>IC</b> New Construction / IC Rated Housing / Airtight	<b>FC1</b> Full Color plus Tunable White, Dynamically Variable through DMX controls	<b>IX32A</b> Integral DMX Digital Dimming Driver, to 0.1%, 120V-277V, 32W	<b>R</b> Round  <b>S</b> Square	<b>F</b> Trimmed  <b>P</b> Trimless  <b>M</b> Millwork	<b>F</b> 35° Beam	<b>S</b> Solite	<b>WH</b> White (provided standard)  <b>BL</b> Black  <b>BZ</b> Statuary Bronze  <b>GR</b> Metalized Grey  <b>PR</b> Primer  <b>AC</b> Clear Matte Anodized  <b>AB</b> Black Anodized	<b>00</b>

# Recess 4.5" Infinite Color+ Adjustable

## RECESS 4.5 SPECIFICATIONS

### FIELD REPLACEABLE LED LIGHT ENGINE

is serviceable through the aperture without tools or with a Philips screwdriver. All USAI Lighting light engines feature industry-leading color consistency.

### FIELD REPLACEABLE DRIVER

All integral dimming drivers are located within the fixture housing and are serviceable from below the ceiling through the aperture. Some on-time delay may be experienced depending on control system used. All dimming drivers comply with IEEE C62.41 surge protection.

### HOUSING

All Recess 4.5 fixtures are field-flexible which allow for field changes from trimless or millwork to trimmed with a simple components change with parts from USAI. Housings are fabricated of 20 ga. steel construction with thru wire J-box, 4 in 4 out at min. 90°C, #12 AWG thru branch circuit wiring.

### ADJUSTMENT

362° horizontal locking in 90° increments.

### FIXTURE WEIGHT

NC and IC housings weigh 16 lbs.

### CEILING CUT OUT

Trimmed with Overlap Flange Round: 5-1/16" Ø

Trimmed with Overlap Flange Square: 5-1/16" x 5-1/16"

Trimless Spackle-in Round: 5-1/2" Ø

Trimless Spackle-in Square: 5-1/2" x 5-1/2"

Millwork: Knife-edge Round: 4-15/16" Ø

Millwork: Knife-edge Square: 4-15/16" x 4-15/16"

### LISTINGS

Dry/Damp/Wet location. AC and AB trim finishes are dry/damp only. UL2043 rated for use in air handling plenums. NRTL/CSA-US tested to UL standards. IBEW union made.



### NOTES

- Not for use in corrosive environment
- Use of pressure washer voids warranty

### PHOTOMETRICS

Consult factory or website for IES files. Tested in accordance with IESNA LM79.