

Recess 4.5"

Classic White Adjustable



Photograph: Jess Ross Photography (non-transferrable)

Recess 4.5 inch Classic White Adjustable

An elegant solution for a variety of applications. Featuring clean, architectural grade finishes and two high quality white light options, the Recess 4.5 installs beautifully into all ceiling types, including drywall, stone, and wood and makes every space look its best.

- **Ideal Applications:** Medium to Large-Scaled Spaces
- **Recommended for Ceiling Height:** 14' – 20'
- **Light Type:** Consistent warm or neutral white, soft ambient light

4.5" ADJUSTABLE PERFORMANCE DATA

Classic White		
Shape	Round	Square
Delivered Lumens:	1350	1400
Lumens Per Watt:	56	58
Source Lumens:	1875	
Wattage	24W	
CCT:	2700K or 3000K	
CRI:	90+	
Beamspread:	25°	
	Narrow Beam / Adjustable	

Round Trims



Square Trims



Universal and Field Convertible - Trim | Trimless | Millwork

4' SPACING BETWEEN LIGHT FIXTURES

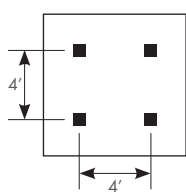

4' x 4' LAYOUT	CEILING HEIGHT
Light levels at:	8' 10' 12' 14' 16' 18' 20'
Light levels on Work Plane (2.5' AFF):	82 74 68 63 58 54 50 (fc) foot candles

5' SPACING BETWEEN LIGHT FIXTURES

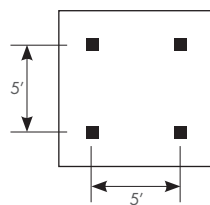

5' x 5' LAYOUT	CEILING HEIGHT
Light levels at:	8' 10' 12' 14' 16' 18' 20'
Light levels on Work Plane (2.5' AFF):	68 60 56 52 49 46 43 (fc) foot candles

6' SPACING BETWEEN LIGHT FIXTURES

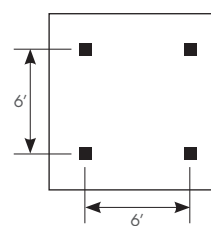

6' x 6' LAYOUT	CEILING HEIGHT
Light levels at:	8' 10' 12' 14' 16' 18' 20'
Light levels on Work Plane (2.5' AFF):	41 41 41 40 39 37 36 (fc) foot candles

8' SPACING BETWEEN LIGHT FIXTURES

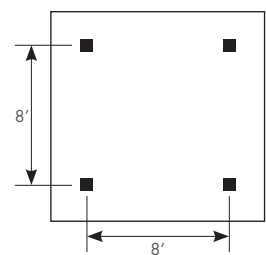

8' x 8' LAYOUT	CEILING HEIGHT
Light levels at:	8' 10' 12' 14' 16' 18' 20'
Light levels on Work Plane (2.5' AFF):	35 31 27 25 23 21 20 (fc) foot candles

Spacing Criteria = 0.45

Average light levels are provided in the tables above, for a range of lighting fixture layouts and ceiling heights. All illuminance values are reported in average footcandles (fc) and measured at the workplane, 30" above the floor.

For approximate light level recommendations, please refer to the IES guidelines shown below:

Workshop / Tools / Crafts: 40-100 fc
Board Games / Cards: 20-40 fc
Dining: 5-10 fc

Kitchen: 30-50 fc
Computer: 15-30 fc
Media: 2-20 fc

Reading: 20-50 fc
Dressing: 10-30 fc
Corridors / Circulation: 3-5 fc

Recess 4.5" Classic White Adjustable



Seven Easy Steps to Specify

1 Select Housing Type

For Ceilings without Insulation		For Insulated Ceilings
<p>New Construction (NC)</p>	<p>Retrofit Housing (RT) Installs From Below in Existing Ceiling</p>	<p>New Construction / IC Rated Housing (IC) Rated for Direct Contact with Insulation</p>

2 Select White Light

<p>Warm White (C27)</p> <p>2700 Kelvin Similar to Incandescent</p>	<p>Neutral White (C30)</p> <p>3000 Kelvin Similar to Halogen</p>
---	---

3 Select Dimming Control Type - Smooth Dimming to 1% Standard

<p>0-10V Low Voltage Dimming (IV24A)</p> <p>Compatible with 0-10V Controls</p>	<p>Phased Line Voltage Dimming (IP24A)</p> <p>Compatible with Forward and Reverse Phase Dimmers</p>
---	--

Recess 4.5" Classic White Adjustable

4 Select Shape

Square



Round



5 Select Trim Style For Ceiling Type

Trimmed (F)
for All Ceiling
Types



Trimless (P)
for Sheetrock Ceilings Only
(Must be Spackled In)



Millwork (M)
for Millwork and
Stone Ceilings



6 Select Glass Lens

Solite (S)
provided standard

Light diffusion
with the most
efficiency



Frosted (F)

Medium diffusion
for softer light
output, approximately
12% less light output



7 Select Trim Finish

White (WH)
provided standard



Black (BL)



Statuary
Bronze (BZ)



Metalized
Grey (GR)



Primer (PR)



Clear Matte
Anodized (AC)



Black
Anodized (AB)



See Next Page For How to Specify

Recess 4.5" Classic White Adjustable



How to Specify

Manufacturer	Light Fixture Type			LED + Control			Options				Revision
USAI	4DL	A1						D			00
USAI	Family	Function	Housing Type	LED Color	Wattage Driver	Shape	Style	Beam Spread	Lens	Finish	Version
USAI Lighting	4DL 4.5" Downlight, 24W	A1 Adjustable Tilt and Aim Downlight	NC New Construction Housing IC New Construction / IC Rated Housing / Airtight	C27 Warm White 2700K High 90+ CRI C30 Neutral White 3000K High 90+ CRI	IP24A Integral Phase Dimming Driver, to 1% 120V only, 24W IV24A Integral 0-10V Dimming Driver, to 1% 120V-277V, 24W	R Round S Square	F Trimmed P Trimless M Millwork	D 25° Beam	S Solite Textured Glass (provided standard) F Frosted Glass	WH White (provided standard) BL Black BZ Statuary Bronze GR Metalized Grey PR Primer AC Clear Matte Anodized AB Black Anodized	00
			RT Trimmed Only Retrofit from below ceiling	C27 Warm White 2700K High 90+ CRI C30 Neutral White 3000K High 90+ CRI	IP24A Integral Phase Dimming Driver, to 1% 120V only, 24W IV24A Integral 0-10V Dimming Driver, to 1% 120V-277V, 24W	R Round S Square	F Trimmed Only (Retrofit Housing)			D 25° Beam	

Recess 4.5" Classic White Adjustable

RECESS 4.5 SPECIFICATIONS

FIELD REPLACEABLE LED LIGHT ENGINE

is serviceable through the aperture without tools or with a Philips screwdriver. All USAI Lighting light engines feature industry-leading color consistency.

FIELD REPLACEABLE DRIVER

All integral dimming drivers are located within the fixture housing and are serviceable from below the ceiling through the aperture. Some on-time delay may be experienced depending on control system used. All dimming drivers comply with IEEE C62.41 surge protection.

HOUSING

All Recess 4.5 fixtures are field-flexible which allow for field changes from trimless or millwork to trimmed with a simple components change with parts from USAI. Housings are fabricated of 20 ga. steel construction with thru wire J-box, 4 in 4 out at min. 90°C, #12 AWG thru branch circuit wiring.

ADJUSTMENT

362° horizontal locking in 90° increments.

FIXTURE WEIGHT

FT and RT housings weigh 8 lbs. IC housings weigh 16 lbs.

CEILING CUT OUT

Trimmed with Overlap Flange Round: 5-1/16" Ø
Trimmed with Overlap Flange Square: 5-1/16" x 5-1/16"
Trimless Spackle-in Round: 5-1/2" Ø
Trimless Spackle-in Square: 5-1/2" x 5-1/2"
Millwork: Knife-edge Round: 4-15/16" Ø
Millwork: Knife-edge Square: 4-15/16" x 4-15/16"
Retrofit Round: 5-1/2" Ø
Retrofit Square: 5-1/2" x 5-1/2"

LISTINGS

Dry/Damp/Wet location. AC and AB trim finishes are dry/damp only. UL2043 rated for use in air handling plenums. NRTL/CSA-US tested to UL standards. IBEW union made.



NOTES

- Not for use in corrosive environment
- Use of pressure washer voids warranty

PHOTOMETRICS

Consult factory or website for IES files. Tested in accordance with IESNA LM79.