

Recess 3" for Sloped Ceilings JA8 T24 Classic White Downlight

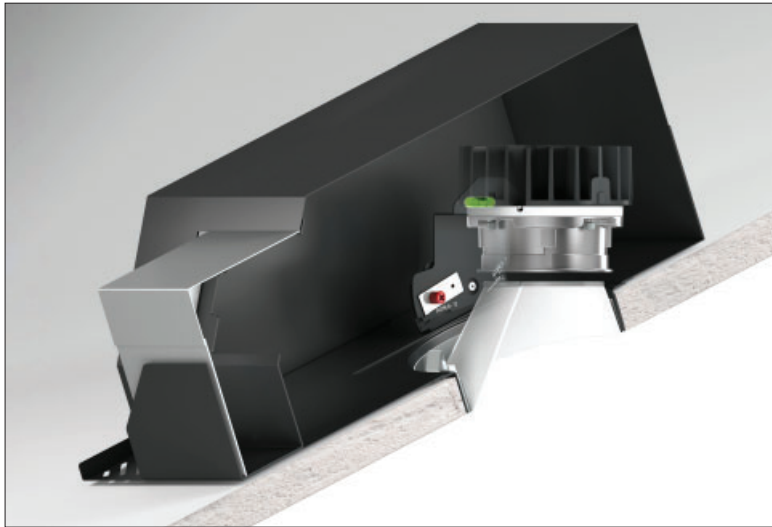

Recess 3 inch JA8 T24 for Sloped Ceilings Classic White Downlight

Now available with CEC T24 2016/2019 JA8 Compliant features for California-based projects with, solutions for angles from 15° (3/12 pitch) to 45° (12/12) pitch to create a perfectly round or square roomside appearance to make every space look its best.

- **Ideal Applications:** Small to Medium-Scaled Spaces
- **Recommended for Ceiling Height:** 8' – 14'
- **Light Type:** Consistent warm or neutral white, soft ambient light



3" DOWNLIGHT PERFORMANCE DATA

Shape	Classic White	
	Round	Square
Delivered Lumens:	925	900
Lumens Per Watt:	63	60
Source Lumens:	1325	
Wattage	15W	
CCT:	2700K or 3000K	
CRI:	90+	
Beamspread:	40°	
	Medium Beam / Straight Down	

Round Trims



Square Trims



Universal and Field Convertible - Trim | Trimless | Millwork

4' SPACING BETWEEN LIGHT FIXTURES

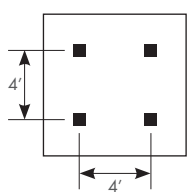

4' x 4' LAYOUT	CEILING HEIGHT
Light levels at:	8' 10' 12' 14'
Light levels on Work Plane (2.5' AFF):	51 46 42 39 (fc) foot candles

5' SPACING BETWEEN LIGHT FIXTURES

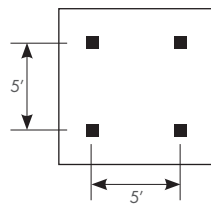

5' x 5' LAYOUT	CEILING HEIGHT
Light levels at:	8' 10' 12' 14'
Light levels on Work Plane (2.5' AFF):	41 37 34 33 (fc) foot candles

6' SPACING BETWEEN LIGHT FIXTURES

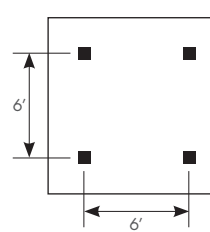

6' x 6' LAYOUT	CEILING HEIGHT
Light levels at:	8' 10' 12' 14'
Light levels on Work Plane (2.5' AFF):	28 28 28 27 (fc) foot candles

8' SPACING BETWEEN LIGHT FIXTURES

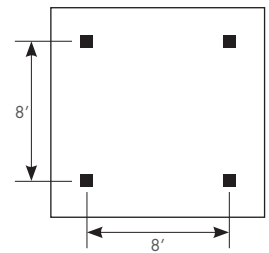

8' x 8' LAYOUT	CEILING HEIGHT
Light levels at:	8' 10' 12' 14'
Light levels on Work Plane (2.5' AFF):	21 18 16 15 (fc) foot candles

Spacing Criteria
 15°-30° Sloped Ceiling: Round: 0.65 / Square: 0.76
 30°-45° Sloped Ceiling: Round: (0-180): 0.58, (90-270) 0.52 / Square: (0-180) .46, (90-270) 0.70

Average light levels are provided in the tables above, for a range of lighting fixture layouts and ceiling heights. All illuminance values are reported in average footcandles (fc) and measured at the workplane, 30" above the floor.

For approximate light level recommendations, please refer to the IES guidelines shown below:

- | | | |
|---|---------------------------|--|
| Workshop / Tools / Crafts: 40-100 fc | Kitchen: 30-50 fc | Reading: 20-50 fc |
| Board Games / Cards: 20-40 fc | Computer: 15-30 fc | Dressing: 10-30 fc |
| Dining: 5-10 fc | Media: 2-20 fc | Corridors / Circulation: 3-5 fc |

Recess 3" for Sloped Ceilings JA8 T24 Classic White Downlight



Seven Easy Steps to Specify

1 Select Ceiling Slope

For 15° (3/12) - 30° (7/12) Sloped Ceilings

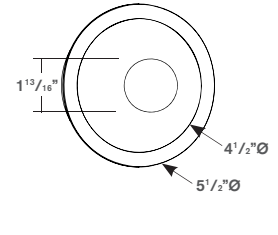
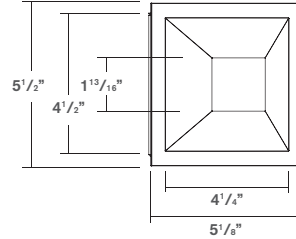
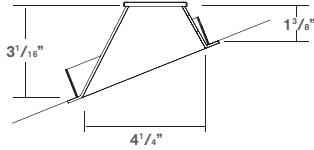

For 30° (7/12) - 45° (12/12) Sloped Ceilings

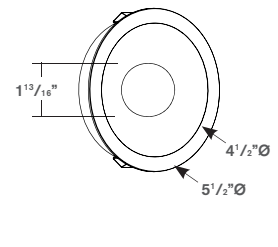
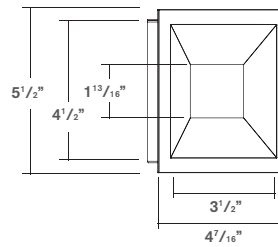
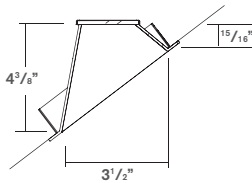

2 Select Housing Type

For Insulated Ceilings

New Construction / IC Rated Housing - (IS)
Rated for Direct Contact with Insulation

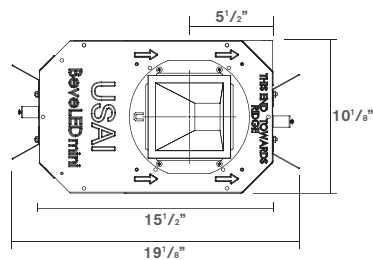
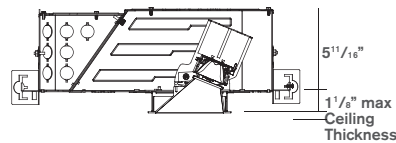

3 Select White Light

Warm White (C27)



2700 Kelvin
Similar to Incandescent

Neutral White (C30)



3000 Kelvin
Similar to Halogen

Recess 3" for Sloped Ceilings JA8 T24 Classic White Downlight



4 Select Dimming Control Type - Smooth Dimming to 1% Standard

0-10V Low Voltage Dimming
(IV15A)



Compatible with 0-10V Controls

Phased Line Voltage Dimming
(IP15A)

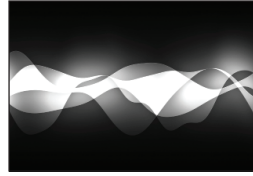

Compatible with Forward and Reverse Phase Dimmers

5 Select Shape

Square



Round



6 Select Trim Style For Ceiling Type

Trimmed (F)
for All Ceiling
Types



Trimless (P)
for Sheetrock Ceilings Only
(Must be Spackled In)



Millwork (M)
for Millwork and
Stone Ceilings



7 Select Trim Finish

White (WH)
provided standard



Black (BL)



Statuary
Bronze (BZ)



Metalized
Grey (GR)



Primer (PR)



How to Specify

Manufacturer	Light Fixture Type			LED + Control		Options					Revision
USAI	3DL		IS		IV15A			G	S		J8
USAI	Family	Function	Housing Type	LED Color	Wattage Driver	Shape	Style	Beam Spread	Lens	Finish	Version
USAI Lighting	3DL 3" Downlight, 15W	S3 For 15°-30° Sloped Ceilings S5 For 30° -45° Sloped Ceilings	IS Insulation Contact Sloped	C27 Warm White 2700K High 90+ CRI C30 Neutral White 3000K High 90+ CRI	IV15A Integral 0-10V Dimming Driver, to 1% 120V-277V, 15W	R Round S Square	F Trimmed P Trimless M Millwork	G 40° Beam	S Solite Textured Glass (provided standard)	WH White (provided standard) BL Black BZ Statuary Bronze GR Metalized Grey PR Primer	J8



SAVANT

www.savant.com
savantsupport@savant.com

1-877-SAVANT5
(1-877-728-2685)

©2020. USAI, LLC.
All rights reserved.
All designs protected by copyright.
Covered by US Patents. Patents pending.

Recess 3" for Sloped Ceilings JA8 T24 Classic White Downlight for Sloped Ceilings

RECESS 3 SLOPED SPECIFICATIONS

FIELD REPLACEABLE LED LIGHT ENGINE

is serviceable through the aperture without tools. All USAI Lighting Classic White light engines feature industry leading color consistency within a 2-Step MacAdam's ellipse.

FIELD REPLACEABLE DRIVER

Driver complies with IEEE62.41 surge protection. Multiple dimming driver options are available; some on-time delay may be experienced, depending on control system used.

ADJUSTMENT:

Sloped ceiling housings are fitted with an integral bubble leveling device to ensure perfectly level installations and optical alignment. Optical assembly can be tilted and locked in position for ceiling slopes from 3/12 pitch to 12/12 pitch, which are visually indicated on tilt mechanism. Butterfly brackets are imprinted with ceiling thickness indexing allow installers to easily preset housing prior to installation: choose from ceiling thicknesses of 1/2", 5/8", 3/4", 7/8", 1", or 1-1/8".

HOUSING:

Fabricated of 20 ga. galvanized steel with thru wire J-box, 4 in 4 out at min. 90°C, #12 AWG thru branch circuit wiring. IC-rated housings for use with 15W light engines only are rated for direct contact with insulation of R-42 or less.

MOUNTING:

Butterfly brackets and adjustable nailer bars with integral nails provided. Nailer bars are extendible from 16" to 24" centers.

CEILING CUT OUT:

Round Trimmed: 5-1/16"Ø
Round Trimless: 5-1/16"Ø
Round Millwork: 4-15/16"Ø
Square Trimmed: 5-1/16" X 5-1/16"
Square Trimless: 5-1/16" X 5-1/16"
Square Millwork: 4-15/16" X 4-15/16"

LISTINGS:

Dry/Damp/Wet location rated. CEC / Title 24 2016 JA8 Compliant, see CEC website for exact models included. NRTL/CSA-US tested to UL standards. IBEW union made.



NOTES:

- Not for use in corrosive environment.
- Use of pressure washer voids warranty.

PHOTOMETRICS:

Consult factory or website for IES files. Tested in accordance with IESNA LM79.