

# Core 3"

## Dim to Warm Downlight



Photograph: ©Elliott Kaufman Photography

### Core 3 inch Dim to Warm Downlight

Recessed downlights that are economically priced and competitive, Core 3 delivers white light that dims to warm while still achieving price targets for budget conscious projects.

- **Ideal Applications:** Small to Medium-Scaled Spaces
- **Recommended for Ceiling Height:** 8' – 14'
- **Light Type:** White light that dims to warm

### 3" DOWNLIGHT PERFORMANCE DATA

Shape	Dim to Warm	
	Round	Square
<b>Delivered Lumens:</b>	825	850
<b>Lumens Per Watt:</b>	59	61
<b>Source Lumens:</b>	1150	
<b>Wattage</b>	15W	
<b>CCT:</b>	3000K	
<b>CRI:</b>	90+	
<b>Beamspread:</b>	25°, 50°	
	Wide Beam / Straight Down	



#### Round Trimmed



#### Square Trimmed

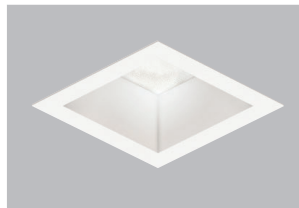

#### 4' SPACING BETWEEN LIGHT FIXTURES

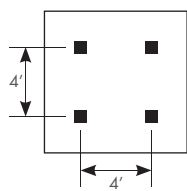

4' x 4' LAYOUT	CEILING HEIGHT
Light levels at:	8' 10' 12' 14'
Light levels on Work Plane (2.5' AFF):	45 40 36 32 (fc) foot candles

#### 5' SPACING BETWEEN LIGHT FIXTURES

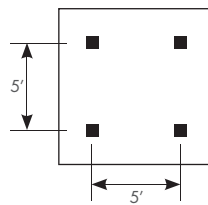

5' x 5' LAYOUT	CEILING HEIGHT
Light levels at:	8' 10' 12' 14'
Light levels on Work Plane (2.5' AFF):	36 33 30 28 (fc) foot candles

#### 6' SPACING BETWEEN LIGHT FIXTURES

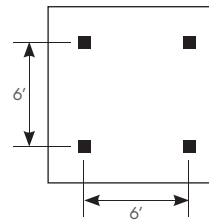

6' x 6' LAYOUT	CEILING HEIGHT
Light levels at:	8' 10' 12' 14'
Light levels on Work Plane (2.5' AFF):	25 25 24 23 (fc) foot candles

#### 8' SPACING BETWEEN LIGHT FIXTURES

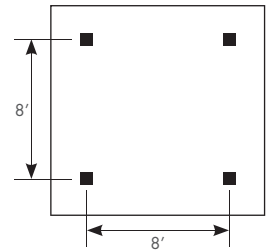

8' x 8' LAYOUT	CEILING HEIGHT
Light levels at:	8' 10' 12' 14'
Light levels on Work Plane (2.5' AFF):	19 15 14 12 (fc) foot candles

Spacing Criteria for 50° beam = 0.76

Average light levels are provided in the tables above, for a range of lighting fixture layouts and ceiling heights. All illuminance values are reported in average footcandles (fc) and measured at the workplane, 30" above the floor using 50° beam.

**For approximate light level recommendations, please refer to the IES guidelines shown below:**

**Workshop / Tools / Crafts:** 40-100 fc  
**Board Games / Cards:** 20-40 fc  
**Dining:** 5-10 fc

**Kitchen:** 30-50 fc  
**Computer:** 15-30 fc  
**Media:** 2-20 fc

**Reading:** 20-50 fc  
**Dressing:** 10-30 fc  
**Corridors / Circulation:** 3-5 fc

# Core 3" Dim to Warm Downlight



## Four Easy Steps to Specify

### 1 Select Housing Type

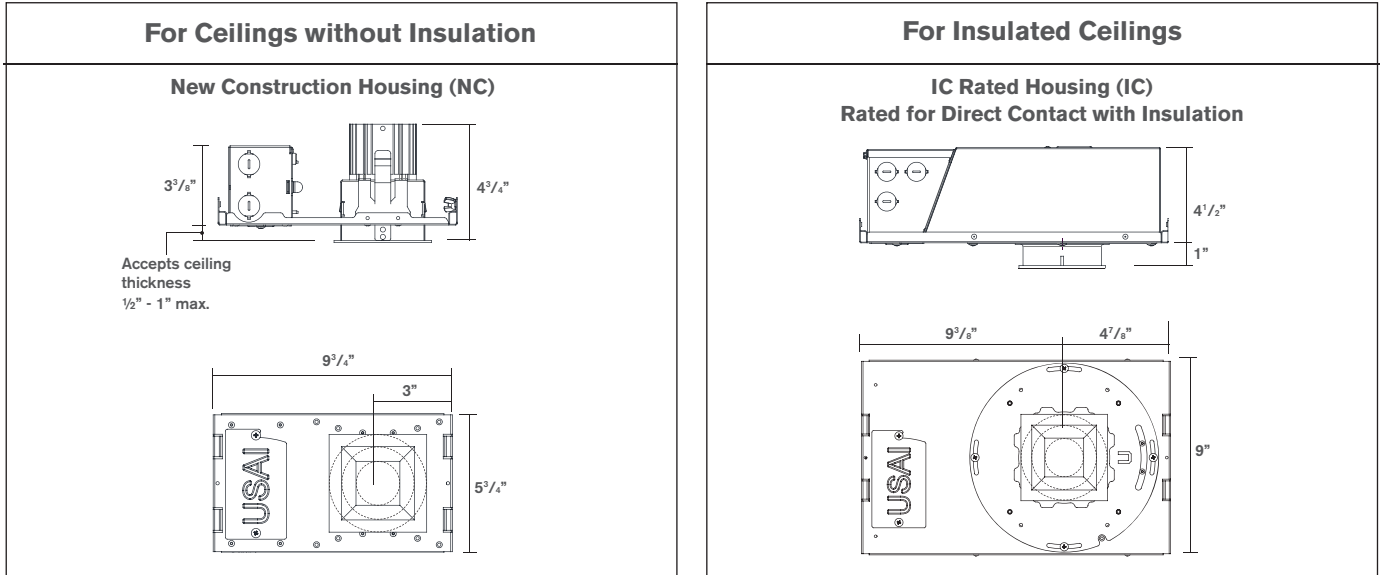

### 2 Select Dimming Control Type - Smooth Dimming to 1% Standard

Select any of these dimming driver options for use with Savant Control Systems

0-10V Low Voltage Dimming (IV15D22)



Compatible with 0-10V Controls

Phased Line Voltage Dimming (IP15D21)

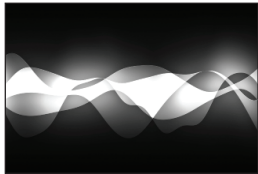

Compatible with Forward and Reverse Phase Dimmers

### 3 Select Shape

Square

Round

Trims are provided with flange, in white finish and a solite glass lens

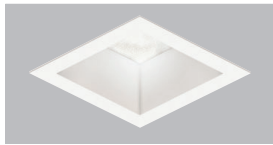

### 4 Select Beam Spread

25° Beam (D)

50° Beam (I)



25°



50°

# Core 3"

## Dim to Warm Downlight



### How to Specify

Manufacturer	Light Fixture Type			LED + Control Type Driver			Options				Revision
USAI	3CR	D1		D30			F		S	WH	00
USAI	Family	Function	Housing Type	LED Color	Wattage Driver	Shape	Style	Beam Spread	Lens	Finish	Version
USAI Lighting	3CR 3" Core Downlight, 15W	D1 Fixed Downlight	NC New Construction Housing  IC Insulation-Contact Rated Housing / Airtight	D30 Neutral white 3000K Dim to Warm, High 90+ CRI	<b>SAVANT CONTROLS</b>  IP15D21 Integral Phase Dimming Driver, to 1% 120V only, 15W  IV15D22 Integral 0-10V Dimming Driver, to 1% 120V-277V, 15W	R Round  S Square	F Trimmed	D 25° beam  I 50° beam	S Solite Textured Glass	WH White	00

### CORE 3 SPECIFICATIONS

#### FIELD REPLACEABLE LED LIGHT ENGINE

is serviceable through the aperture with a screwdriver. All USAI Lighting light engines feature industry leading color consistency Dim to Warm light engines gradually shift color to an amber 1800K when dimmed.

#### FIELD REPLACEABLE DRIVER

Driver complies with IEEE62.41 surge protection. Multiple dimming driver options are available; some on-time delay may be experienced, depending on control system used.

#### HOUSING

Fabricated of black electrocoated 20 ga. steel with 18 ga. steel thru wire J-box, 4 in 4 out at min. 90°C, #12 AWG thru branch circuit wiring. IC-rated housings are rated for direct contact with insulation.

#### MOUNTING

Adjustable nailer bars with integral nails provided. Nailer bars are extendible from 14" to 24" centers.

#### CEILING CUT OUT

Round: 3-5/8" Ø  
Square: 3-1/2" x 3-1/2"

#### LISTINGS

Dry/Damp/Wet location. NRTL/CSA-US tested to UL standards. IBEW union made. 

#### NOTES

- Not for use in corrosive environment.
- Use of pressure washer voids warranty.

#### PHOTOMETRICS

Consult factory or website for IES files. Tested in accordance with IESNA LM79.