

Core 3"

Dim to Warm Adjustable



Photograph: ©Elliott Kaufman Photography

Core 3 inch Dim to Warm Adjustable

Recessed downlights that are economically priced and competitive, Core 3 delivers white light that dims to warm while still achieving price targets for budget conscious projects.

- **Ideal Applications:** Small to Medium-Scaled Spaces
- **Recommended for Ceiling Height:** 8' – 14'
- **Light Type:** White light that dims to warm

3" ADJUSTABLE PERFORMANCE DATA

Shape	Dim to Warm	
	Round	Square
Delivered Lumens:	600	675
Lumens Per Watt:	43	49
Source Lumens:	1150	
Wattage	15W	
CCT:	3000K	
CRI:	90+	
Beamspread:	25°	
	Narrow Beam / Adjustable	

Round Trimmed



Square Trimmed

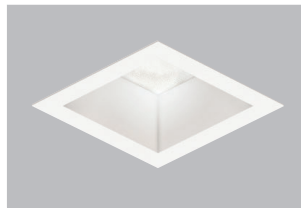

4' SPACING BETWEEN LIGHT FIXTURES

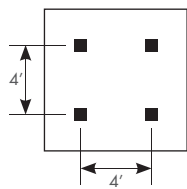

4' x 4' LAYOUT	CEILING HEIGHT			
Light levels at:	8'	10'	12'	14'
Light levels on Work Plane (2.5' AFF):	36	32	29	27
	(fc) foot candles			

5' SPACING BETWEEN LIGHT FIXTURES

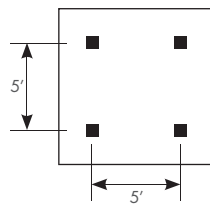

5' x 5' LAYOUT	CEILING HEIGHT			
Light levels at:	8'	10'	12'	14'
Light levels on Work Plane (2.5' AFF):	29	26	24	23
	(fc) foot candles			

6' SPACING BETWEEN LIGHT FIXTURES

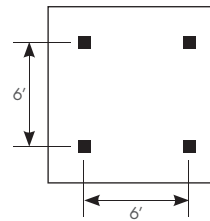

6' x 6' LAYOUT	CEILING HEIGHT			
Light levels at:	8'	10'	12'	14'
Light levels on Work Plane (2.5' AFF):	19	18	18	18
	(fc) foot candles			

8' SPACING BETWEEN LIGHT FIXTURES

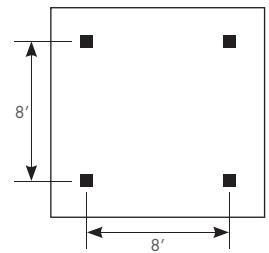

8' x 8' LAYOUT	CEILING HEIGHT			
Light levels at:	8'	10'	12'	14'
Light levels on Work Plane (2.5' AFF):	15	13	12	11
	(fc) foot candles			

Spacing Criteria = 0.47

Average light levels are provided in the tables above, for a range of lighting fixture layouts and ceiling heights. All illuminance values are reported in average footcandles (fc) and measured at the workplane, 30" above the floor.

For approximate light level recommendations, please refer to the IES guidelines shown below:

Workshop / Tools / Crafts: 40-100 fc
Board Games / Cards: 20-40 fc
Dining: 5-10 fc

Kitchen: 30-50 fc
Computer: 15-30 fc
Media: 2-20 fc

Reading: 20-50 fc
Dressing: 10-30 fc
Corridors / Circulation: 3-5 fc

Core 3" Dim to Warm Adjustable



Three Easy Steps to Specify

1 Select Housing Type

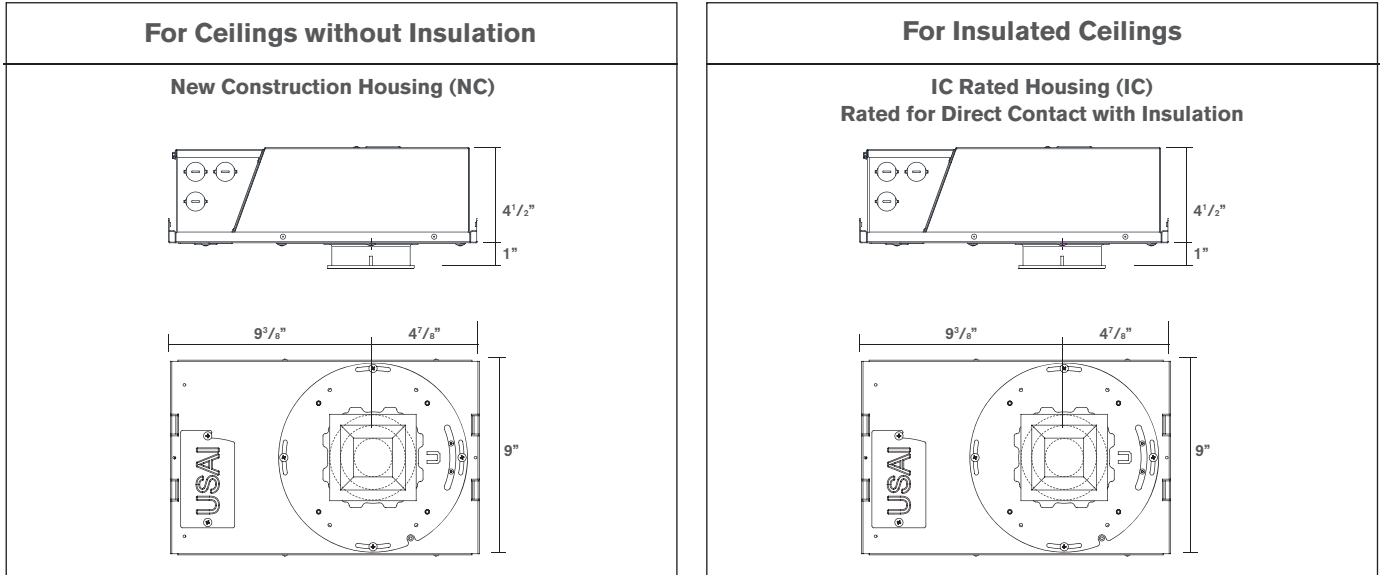

2 Select Dimming Control Type - Smooth Dimming to 1% Standard

Select any of these dimming driver options for use with Savant Control Systems

0-10V Low Voltage Dimming (IV15D22)



Compatible with 0-10V Controls

Phased Line Voltage Dimming (IP15D21)

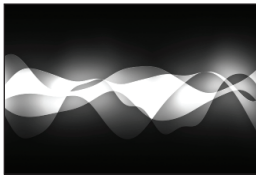

Compatible with Forward and Reverse Phase Dimmers

3 Select Shape

Square

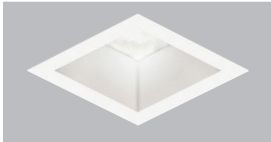

Trims are provided with flange, in white finish and a solite glass lens

Round



See Next Page For How to Specify

Core 3"

Dim to Warm Adjustable



How to Specify

Manufacturer		Light Fixture Type			LED + Control Type Driver			Options				Revision
USAI	3CR	A1		D30			F	D	S	WH	00	
USAI	Family	Function	Housing Type	LED Color	Wattage Driver	Shape	Style	Beam Spread	Lens	Finish	Version	
USAI Lighting	3CR 3" Core Downlight, 15W	A1 Adjustable Tilt and Aim Downlight	NC New Construction Housing IC Insulation-Contact Rated Housing / Airtight	D30 Neutral white 3000K AmberDim, High 90+ CRI	SAVANT CONTROLS IP15D21 Integral Phase Dimming Driver, to 1% 120V only, 15W IV15D22 Integral 0-10V Dimming Driver, to 1% 120V-277V, 15W	R Round S Square	F Trimmed	D 25° Beam	S Solite Textured Glass	WH White	00	

CORE 3 SPECIFICATIONS

FIELD REPLACEABLE LED LIGHT ENGINE

is serviceable through the aperture with a screwdriver. All USAI Lighting light engines feature industry leading color consistency Dim to Warm light engines gradually shift color to an amber 1800K when dimmed.

FIELD REPLACEABLE DRIVER

Driver complies with IEEE62.41 surge protection. Multiple dimming driver options are available; some on-time delay may be experienced, depending on control system used.

HOUSING

Fabricated of black electrocoated 20 ga. steel with 18 ga. steel thru wire J-box, 4 in 4 out at min. 90°C, #12 AWG thru branch circuit wiring. IC-rated housings are rated for direct contact with insulation.

MOUNTING

Adjustable nailer bars with integral nails provided. Nailer bars are extendible from 14" to 24" centers.

CEILING CUT OUT

Round: 3-5/8" Ø
Square: 3-1/2" x 3-1/2"

LISTINGS

Dry/Damp/Wet location. NRTL/CSA-US tested to UL standards. IBEW union made. 

NOTES

- Not for use in corrosive environment.
- Use of pressure washer voids warranty.

PHOTOMETRICS

Consult factory or website for IES files. Tested in accordance with IESNA LM79.