

Core 3" Classic White Adjustable



Photograph: Scott Frances

Core 3 inch Classic White Adjustable

Recessed downlights that are economically priced and competitive, Core 3 delivers top quality performance while still achieving price targets for budget conscious projects.

- **Ideal Applications:** Small to Medium-Scaled Spaces
- **Recommended for Ceiling Height:** 8' – 14'
- **Light Type:** Consistent warm or neutral white, soft ambient light

3" ADJUSTABLE PERFORMANCE DATA

Classic White

Shape	Round	Square
Delivered Lumens:	XXXX	XXX
Lumens Per Watt:	XX	XX
Source Lumens:	1275	
Wattage	15W	
CCT:	2700K or 3000K	
CRI:	90+	
Beamspread:	25°	
	Narrow Beam / Adjustable	



Round Trimmed



Square Trimmed

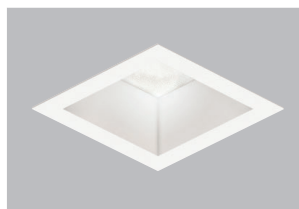

4' SPACING BETWEEN LIGHT FIXTURES

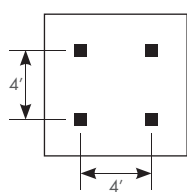

4' x 4' LAYOUT	CEILING HEIGHT
Light levels at:	8' 10' 12' 14'
Light levels on Work Plane (2.5' AFF):	XX XX XX XX (fc) foot candles

5' SPACING BETWEEN LIGHT FIXTURES

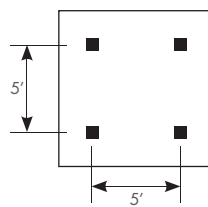

5' x 5' LAYOUT	CEILING HEIGHT
Light levels at:	8' 10' 12' 14'
Light levels on Work Plane (2.5' AFF):	XX XX XX XX (fc) foot candles

6' SPACING BETWEEN LIGHT FIXTURES

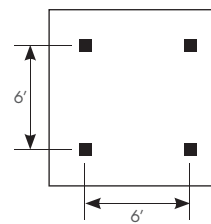

6' x 6' LAYOUT	CEILING HEIGHT
Light levels at:	8' 10' 12' 14'
Light levels on Work Plane (2.5' AFF):	XX XX XX XX (fc) foot candles

8' SPACING BETWEEN LIGHT FIXTURES

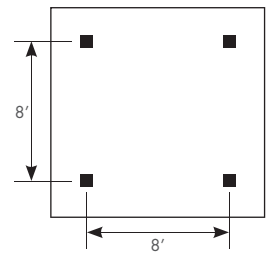

8' x 8' LAYOUT	CEILING HEIGHT
Light levels at:	8' 10' 12' 14'
Light levels on Work Plane (2.5' AFF):	XX XX XX XX (fc) foot candles

Spacing Criteria = XX

Average light levels are provided in the tables above, for a range of lighting fixture layouts and ceiling heights. All illuminance values are reported in average footcandles (fc) and measured at the workplane, 30" above the floor.

For approximate light level recommendations, please refer to the IES guidelines shown below:

Workshop / Tools / Crafts: 40-100 fc
Board Games / Cards: 20-40 fc
Dining: 5-10 fc

Kitchen: 30-50 fc
Computer: 15-30 fc
Media: 2-20 fc

Reading: 20-50 fc
Dressing: 10-30 fc
Corridors / Circulation: 3-5 fc

Core 3" Classic White Adjustable



Four Easy Steps to Specify

1 Select Housing Type

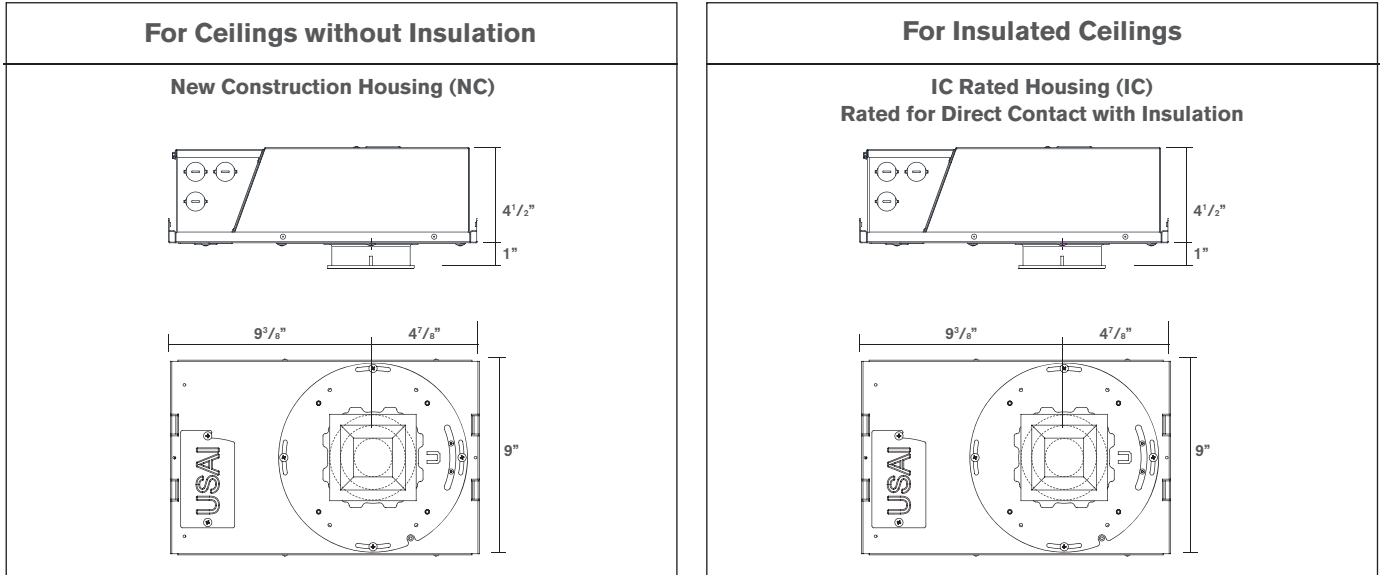

2 Select White Light



3 Select Dimming Control Type - Smooth Dimming to 1% Standard

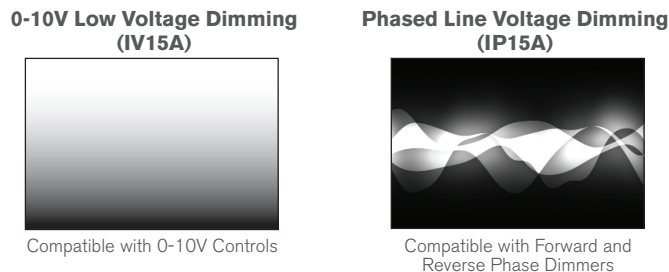

4 Select Shape

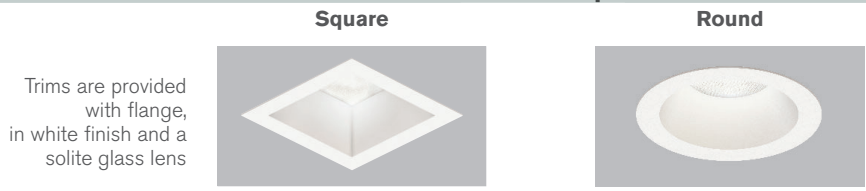

See Next Page For How to Specify

Core 3" Classic White Adjustable



How to Specify

Manufacturer	Light Fixture Type			LED + Control			Options			Revision	
USAI	3CR	A1					F	D	S	WH	00
USAI	Family	Function	Housing Type	LED Color	Wattage Driver	Shape	Style	Beam Spread	Lens	Finish	Version
USAI Lighting	3CR 3" Core Downlight, 15W	A1 Adjustable Tilt and Aim Downlight	NC New Construction Housing IC Insulation-Contact Rated Housing / Airtight	C27 Warm White 2700K High 90+ CRI C30 Neutral White 3000K High 90+ CRI	IP15A Integral Phase Dimming Driver, to 1% 120V only, 15W IV15A Integral 0-10V Dimming Driver, to 1% 120V-277V, 15W	R Round S Square	F Trimmed	D 25° Beam	S Solite Textured Glass	WH White	00

CORE 3 SPECIFICATIONS

FIELD REPLACEABLE LED LIGHT ENGINE

is serviceable through the aperture without tools. All USAI Lighting Classic White light engines feature industry leading color consistency within a 2-Step MacAdam's ellipse.

FIELD REPLACEABLE DRIVER

Driver complies with IEEE62.41 surge protection. Multiple dimming driver options are available; some on-time delay may be experienced, depending on control system used.

HOUSING

Fabricated of black electrocoated 20 ga. steel with 18 ga. steel thru wire J-box, 4 in 4 out at min. 90°C, #12 AWG thru branch circuit wiring. IC-rated housings are rated for direct contact with insulation.

MOUNTING

Adjustable nailer bars with integral nails provided. Nailer bars are extendible from 14" to 24" centers.

CEILING CUT OUT

Round: 3-5/8" Ø
Square: 3-1/2" x 3-1/2"

LISTINGS

Dry/Damp/Wet location. NRTL/CSA-US tested to UL standards. IBEW union made.



NOTES

- Not for use in corrosive environment.
- Use of pressure washer voids warranty.

PHOTOMETRICS

Consult factory or website for IES files. Tested in accordance with IESNA LM79.